

Assembly Instructions - Pi-Box Pro 3

Kit Contains:

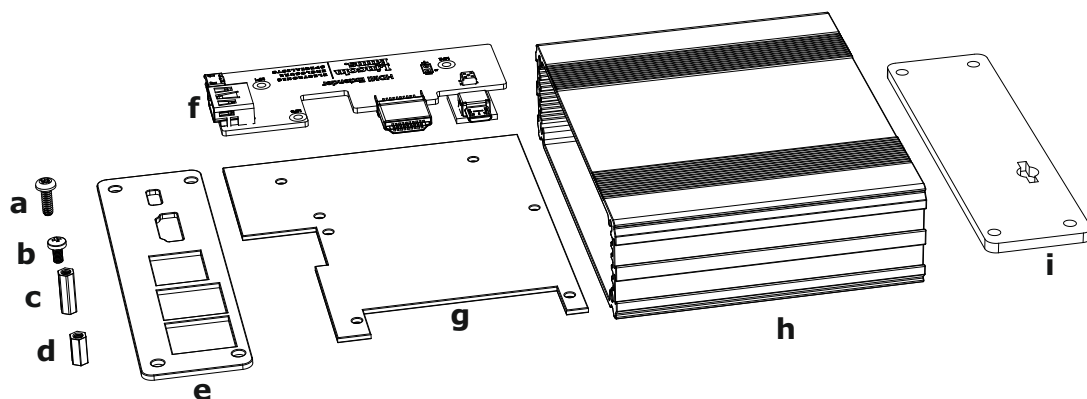

- (a) x8 M3x10 Taptite Screws
- (b) x14 M3x5 Screws
- (c) x4 12mm Standoffs
- (d) x3 8mm Standoffs
- (e) x1 Aluminium End Plate
- (f) x1 HDMI Extender PCB
- (g) x1 Aluminium Carrier Plate
- (h) x1 Aluminium Extrusion
- (i) x1 Acrylic End Plate

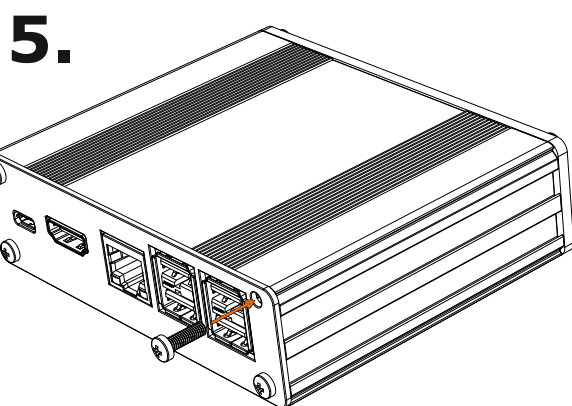
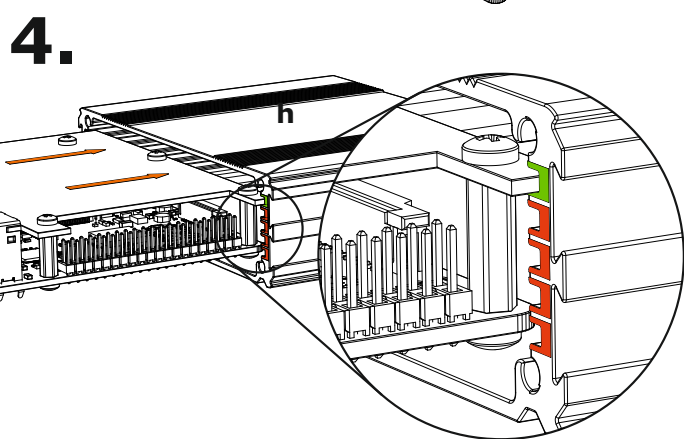
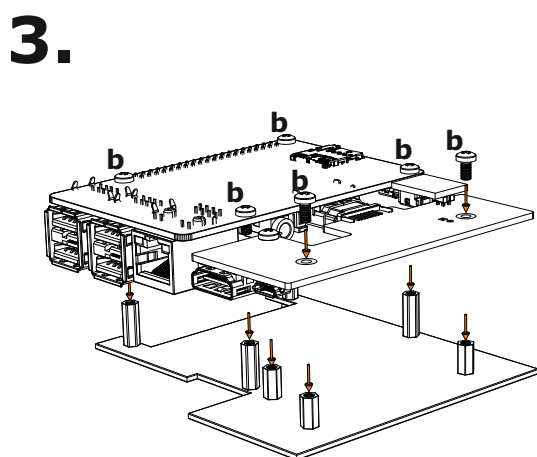
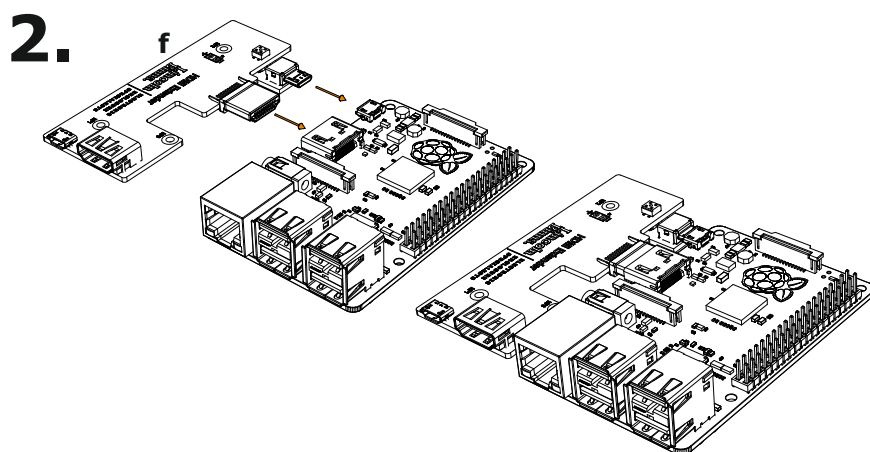
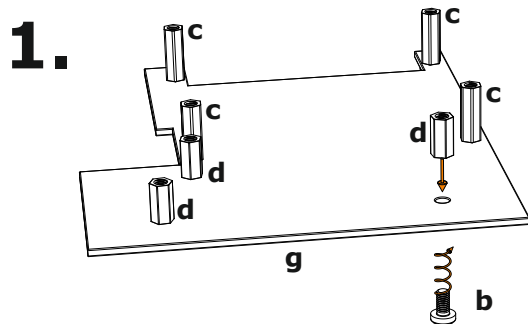

1. Take carrier plate (g) & attach standoffs (c) & (d) with screws (b).
2. Plug extender board (f) into the HDMI & USB connectors on the Raspberry Pi board.
3. Place Raspberry Pi & extender on carrier plate assembly & secure with screws (b) as shown.
4. Turn board assembly over so carrier plate is on top & slide into top slot of extrusion (h) as shown.
5. Attach aluminium (e) & acrylic (i) end plates to extrusion (h) with screws (a).